

NORTH & EAST PANEL

THURSDAY 17th November



Doing our best – to be the Best Council in the Best City

1

APPLICATION: 20/08412/FU

PROPOSAL: Construction of a new community sports hub including 4No. floodlit artificial grass pitches enclosed by metal ball-stop fencing, car parking and associated landscaping works are also proposed to connect the development to the wider Green Park, including a lit footpath link from the Redrow housing development to Austhorpe Primary School; external sub-station and bin store

ADDRESS: Land Off Thorpe Park
Park Approach, Leeds, LS15





© Bluesky International Ltd and Getmapping Plc [2022]

PLANS PANEL PRESENTATION

SCALE 1:3500



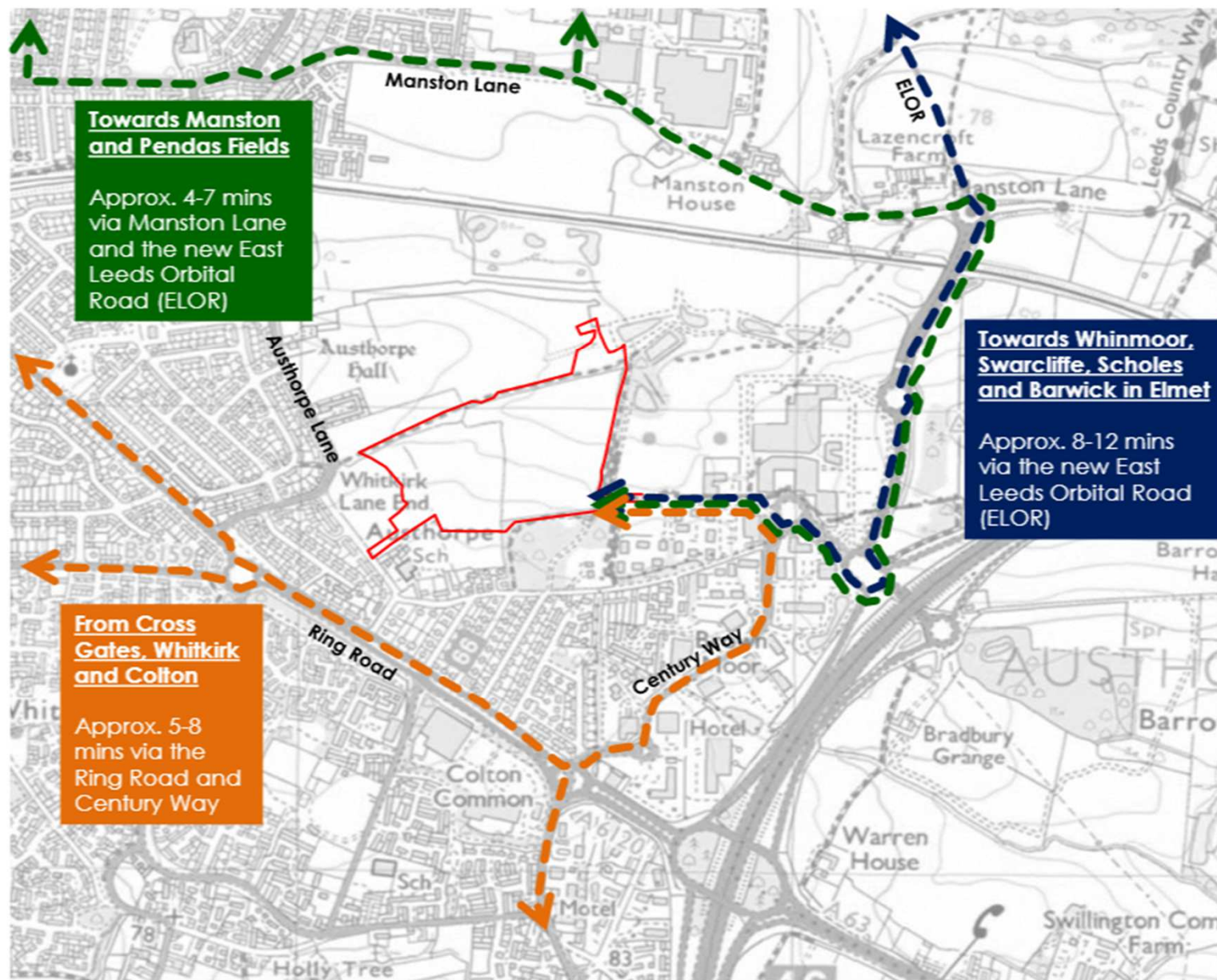

Existing map showing key vehicular routes to the facility

3. Access and Parking

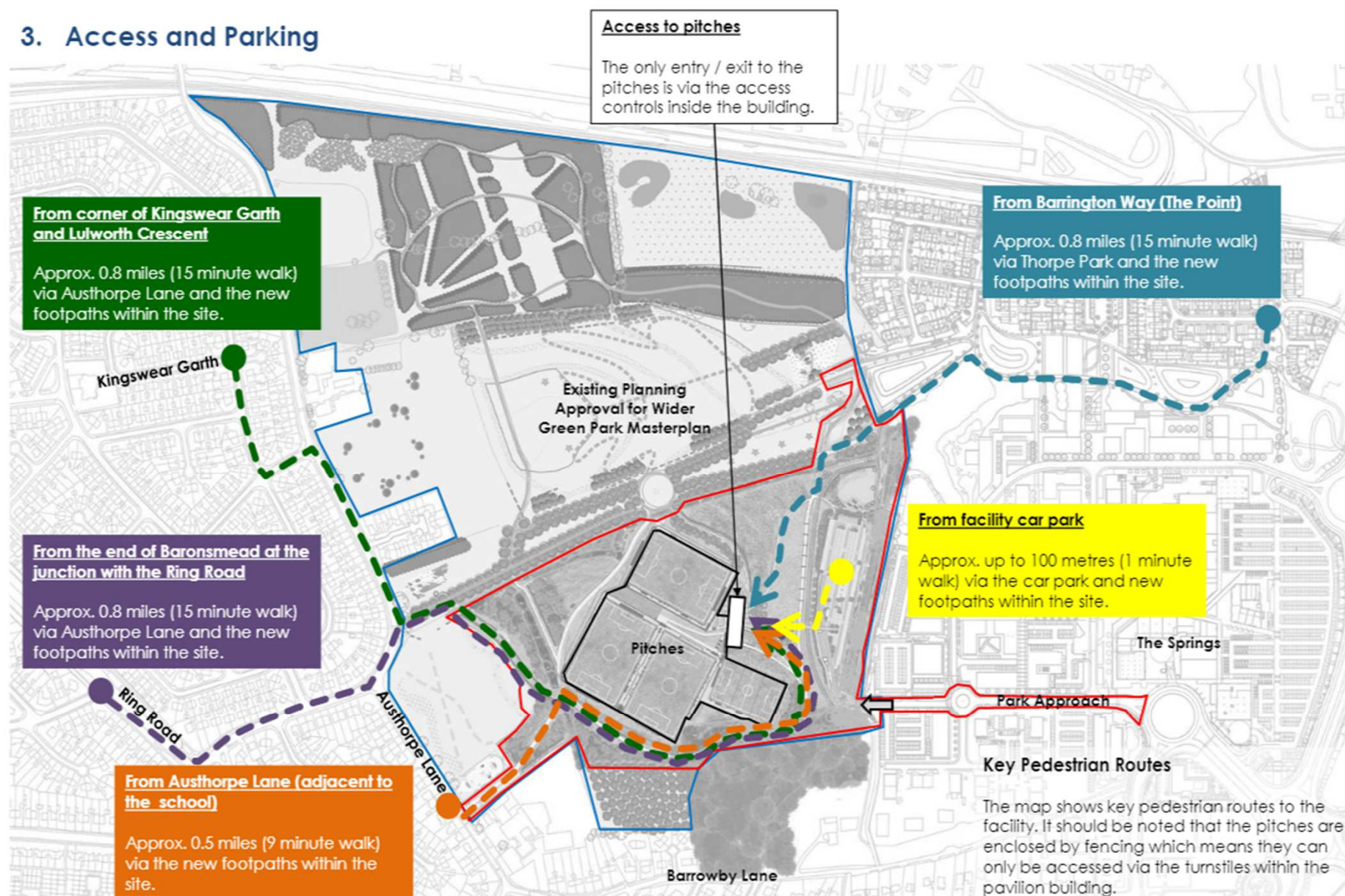

Existing map showing key pedestrian routes to the facility



File Path: C:\Green Park Football Foundation\101064\Drawings\101064-00-D-A-065-001-001.dwg Project: 101064-00-D-A-065-001-001.dwg Printed: 10/10/2024 11:46:30 By: Planning, Service

5. External Lighting

Proposed Site Section A-A

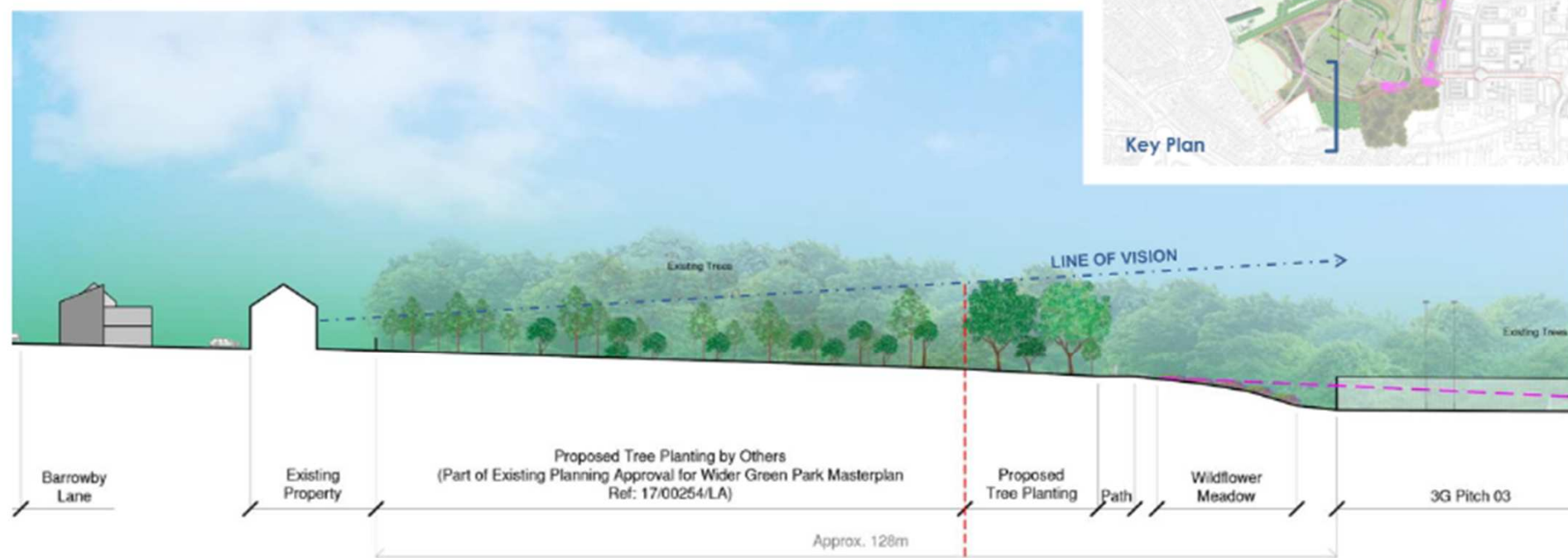

The following measures have been taken in the preparation of the external lighting scheme to limit the potential for glare and stray light:

- Sports pitch floodlights mounted at 12m-15m high to achieve a lower floodlight angle and concentrate lighting onto the sports pitches limiting overspill and glare.
- Post top luminaires within car parking areas mounted on 6m columns to be provided with control optics designed to limit the beam angle within 70 degrees, to avoid glare and upward light distribution.
- The post top luminaires are to be provided with control optics that are designed to provide an asymmetric light distribution to minimise light overspill from the site.
- Louvers fitted to sports pitch lighting to reduce back spill light and provide a more concentrated light distribution to the sports pitches.
- Luminaires to comply with Dark Sky Association Guidance which stipulates that no luminaires with outwards or sideways light distribution shall be used to aid reduction of luminaire intensity.

- Additional measures will also be taken to reduce the impact on bats. In accordance with ILP Guidance Notes 1 and 8 and Eurobats.
- Pitches located over 100 metres away from nearest residential properties;
- Pitches set into the existing slope / topography to provide a buffer between these and the surrounding properties – minimising noise and light impact;
- Tree and shrub planting proposed to further reduce the light impact on surrounding areas.

6. Existing and Proposed Views



6. Existing and Proposed Views



6. Existing and Proposed Views

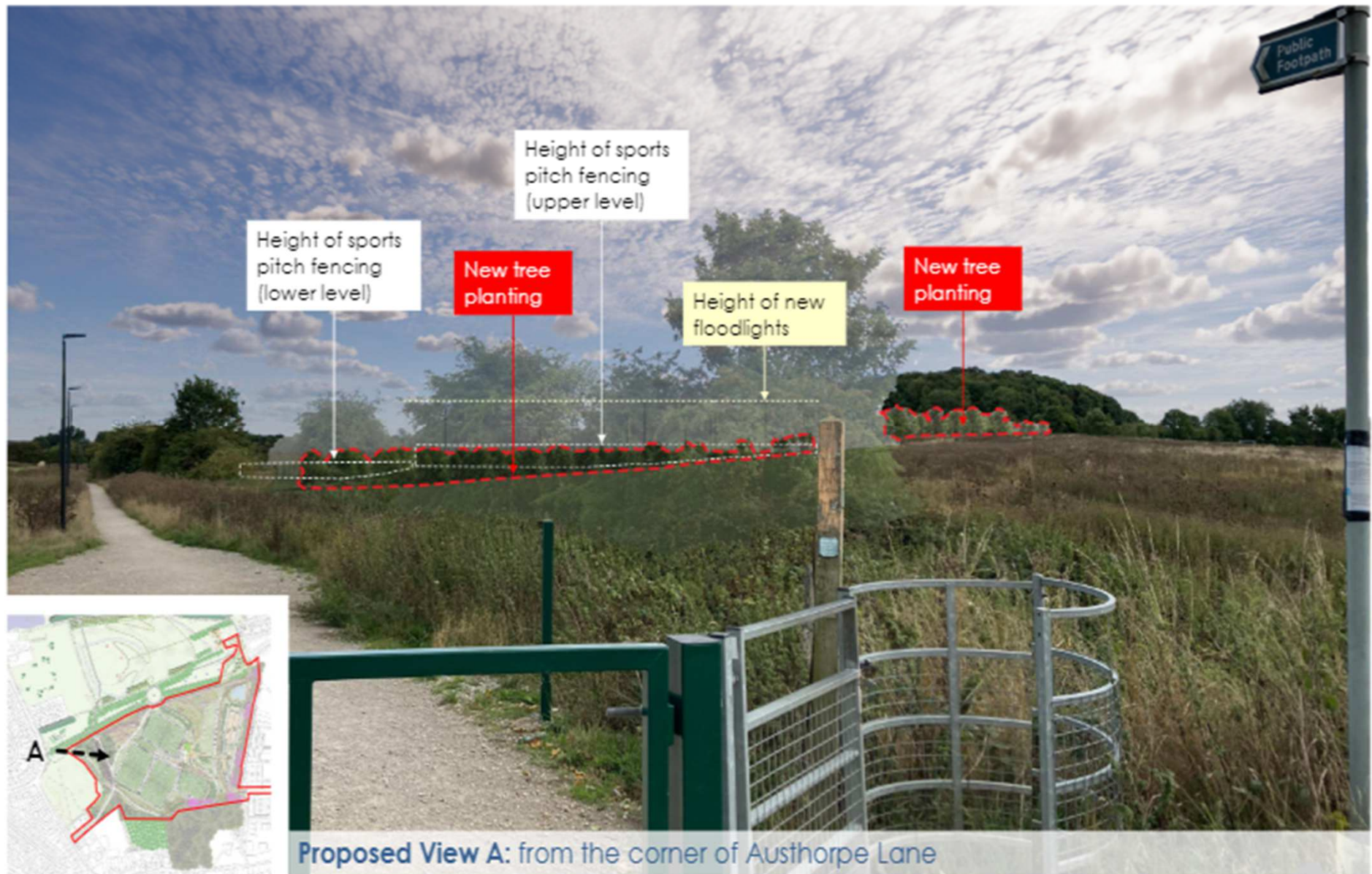

6. Existing and Proposed Views



6. Existing and Proposed Views



6. Existing and Proposed Views



6. Existing and Proposed Views

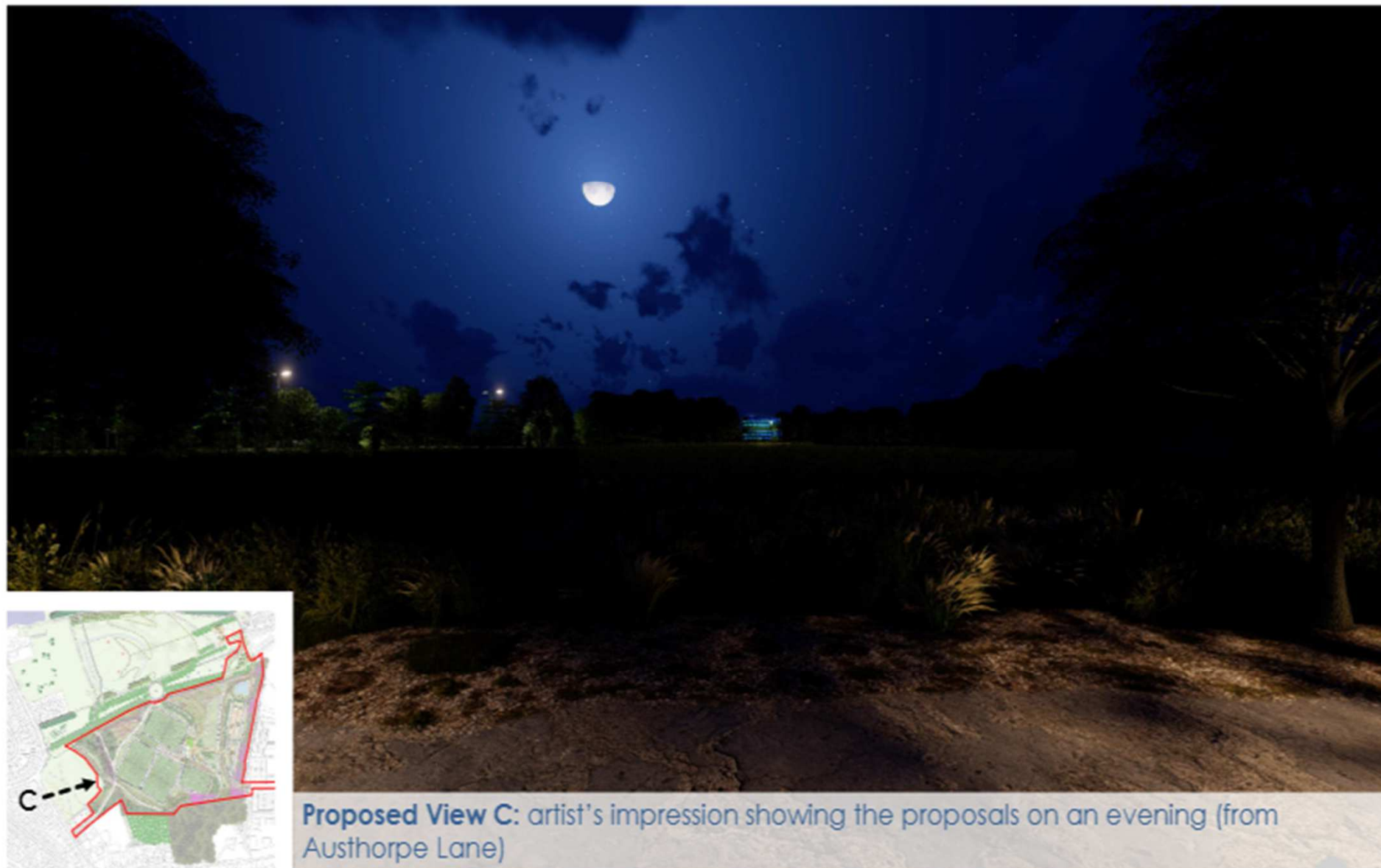

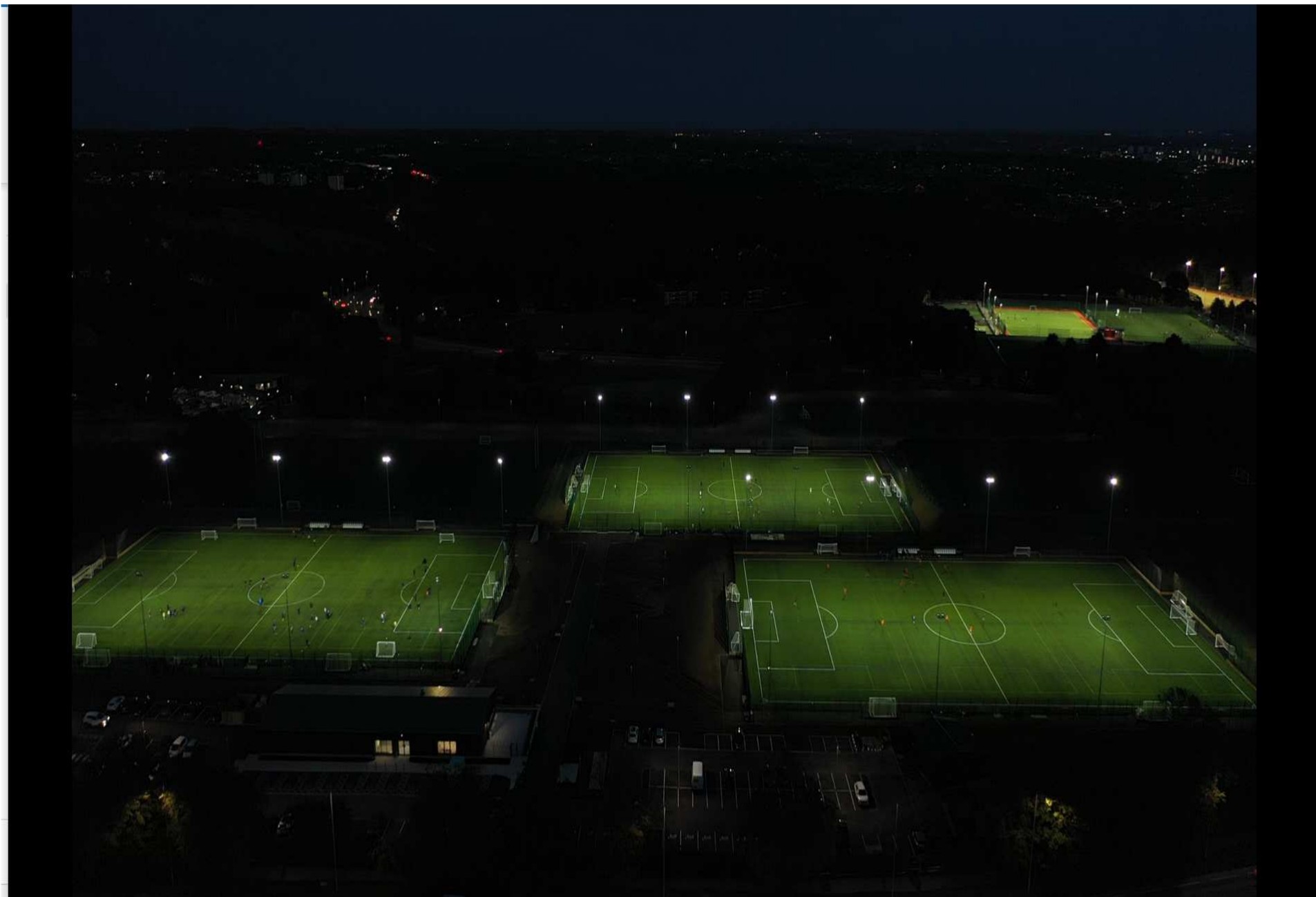

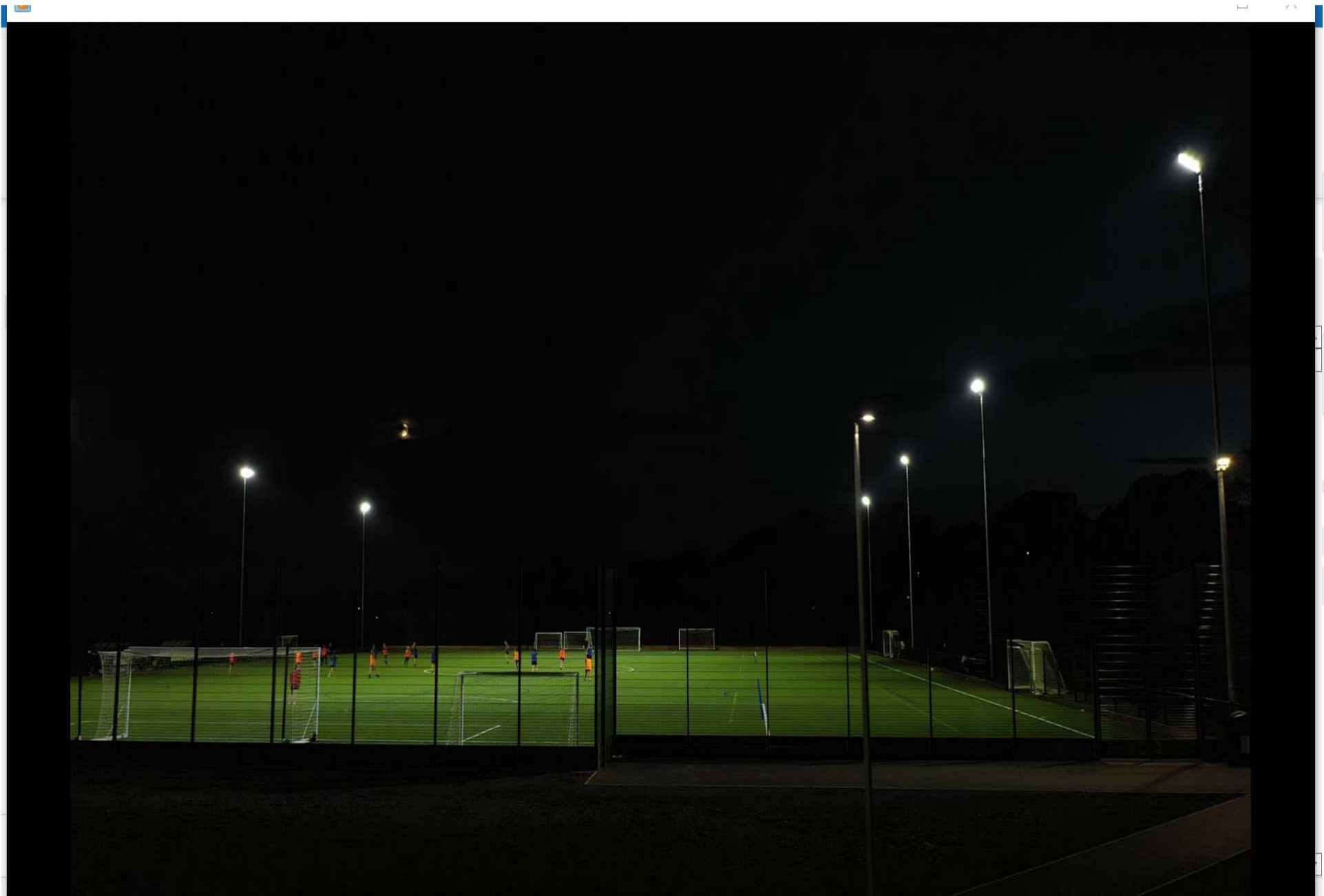





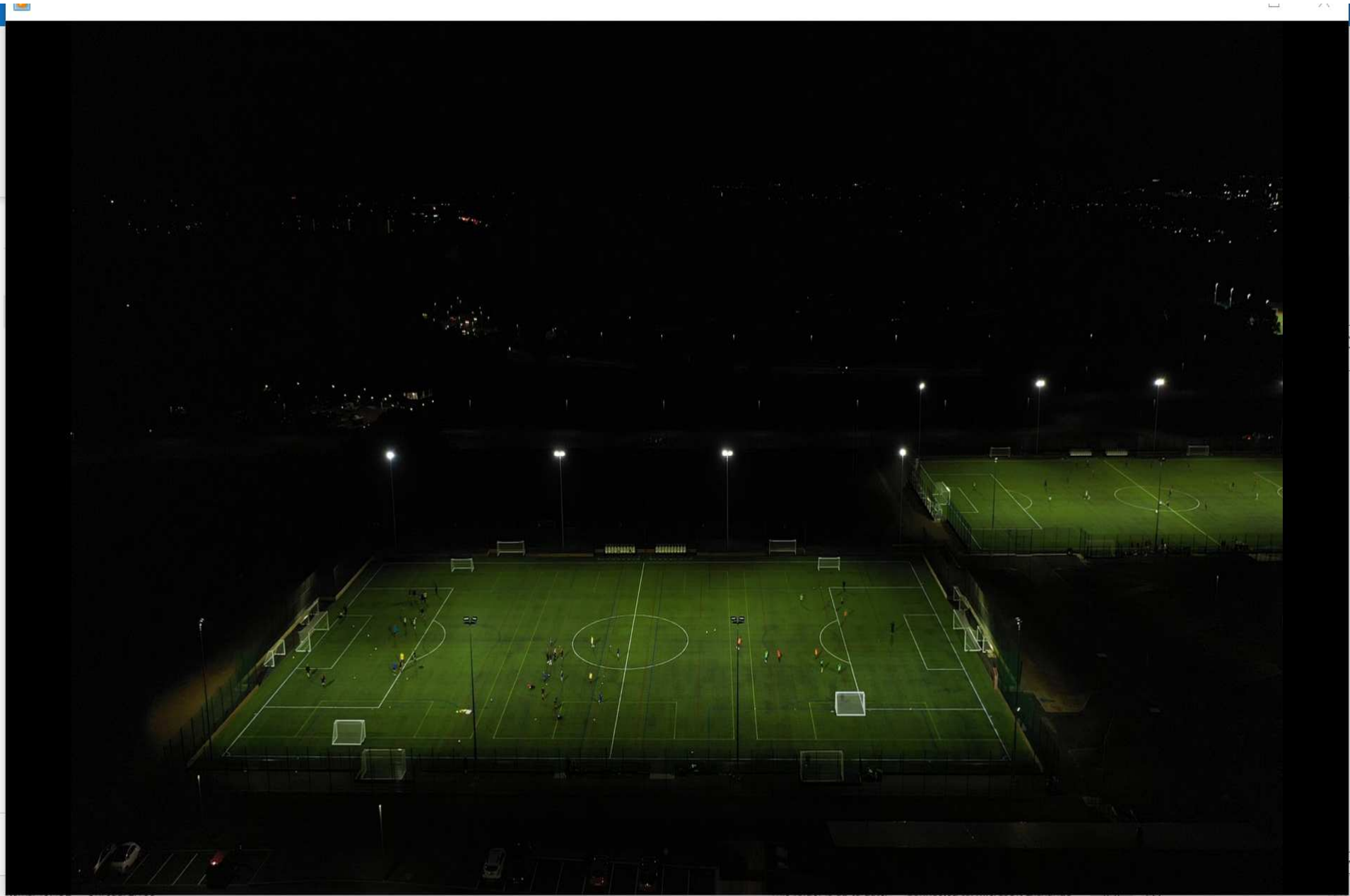





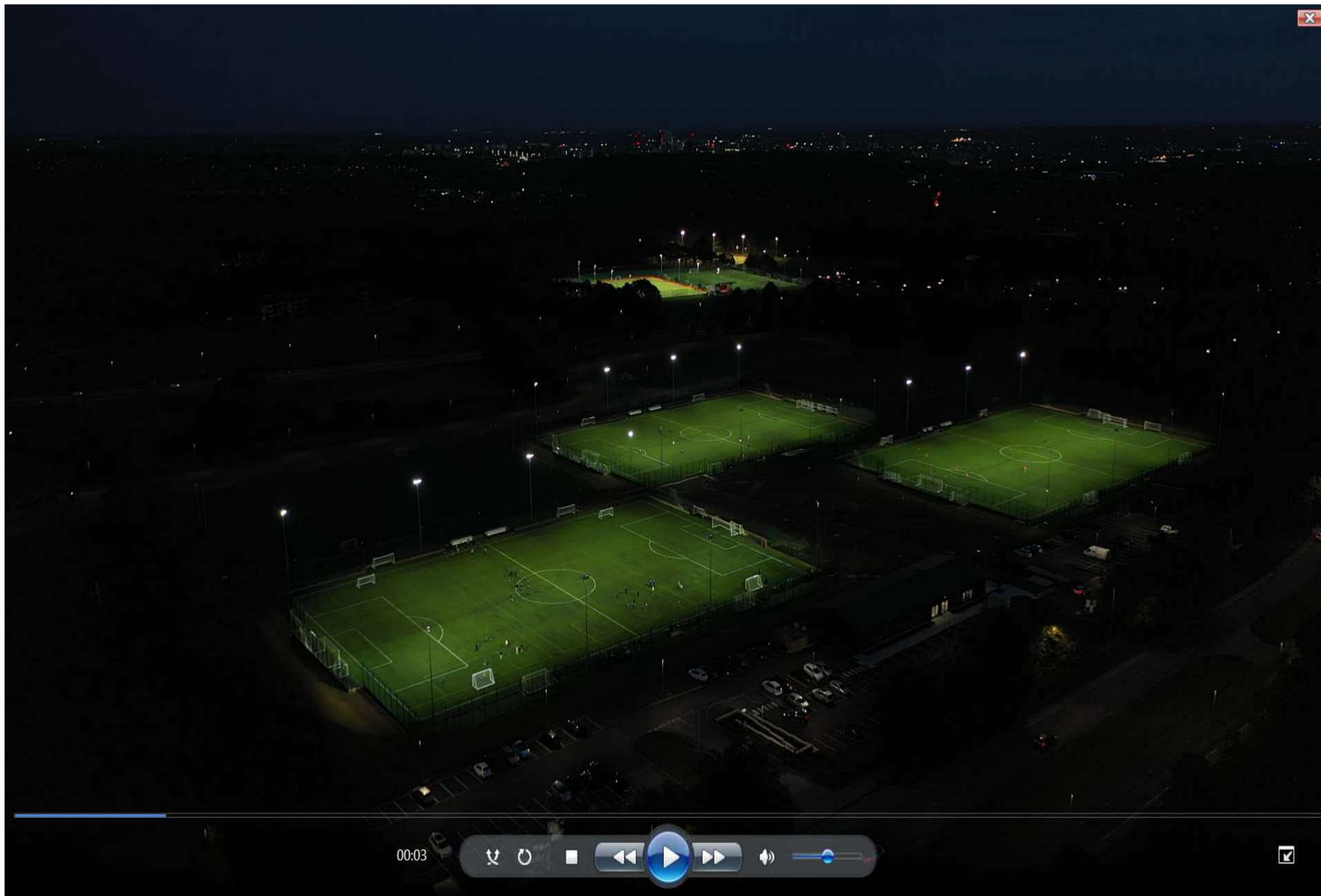

00:03



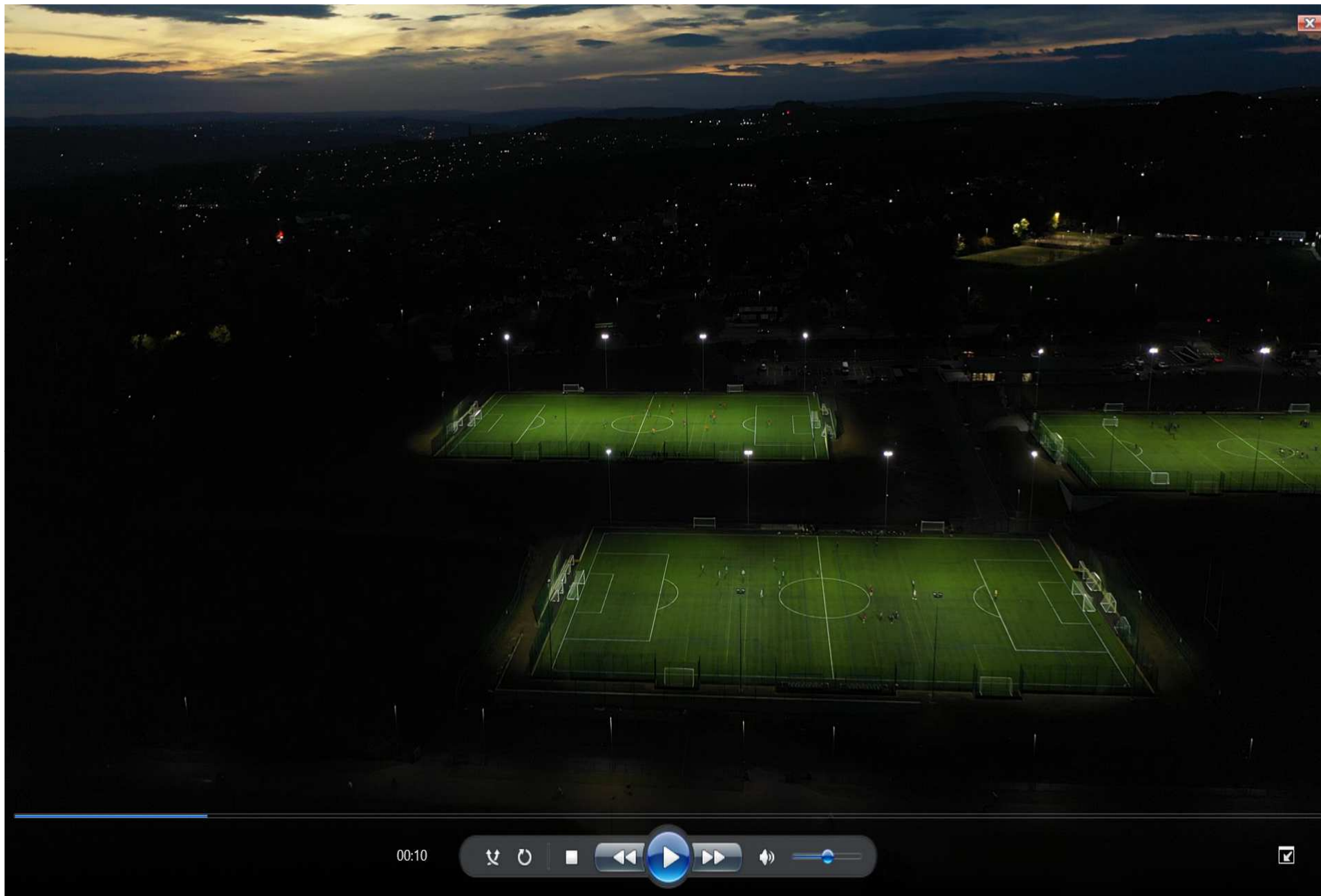

00:10





Example photographs showing detox grids (located at pitch entrances)



Example photographs showing Trekboards which help prevent the spread of rubber crumb

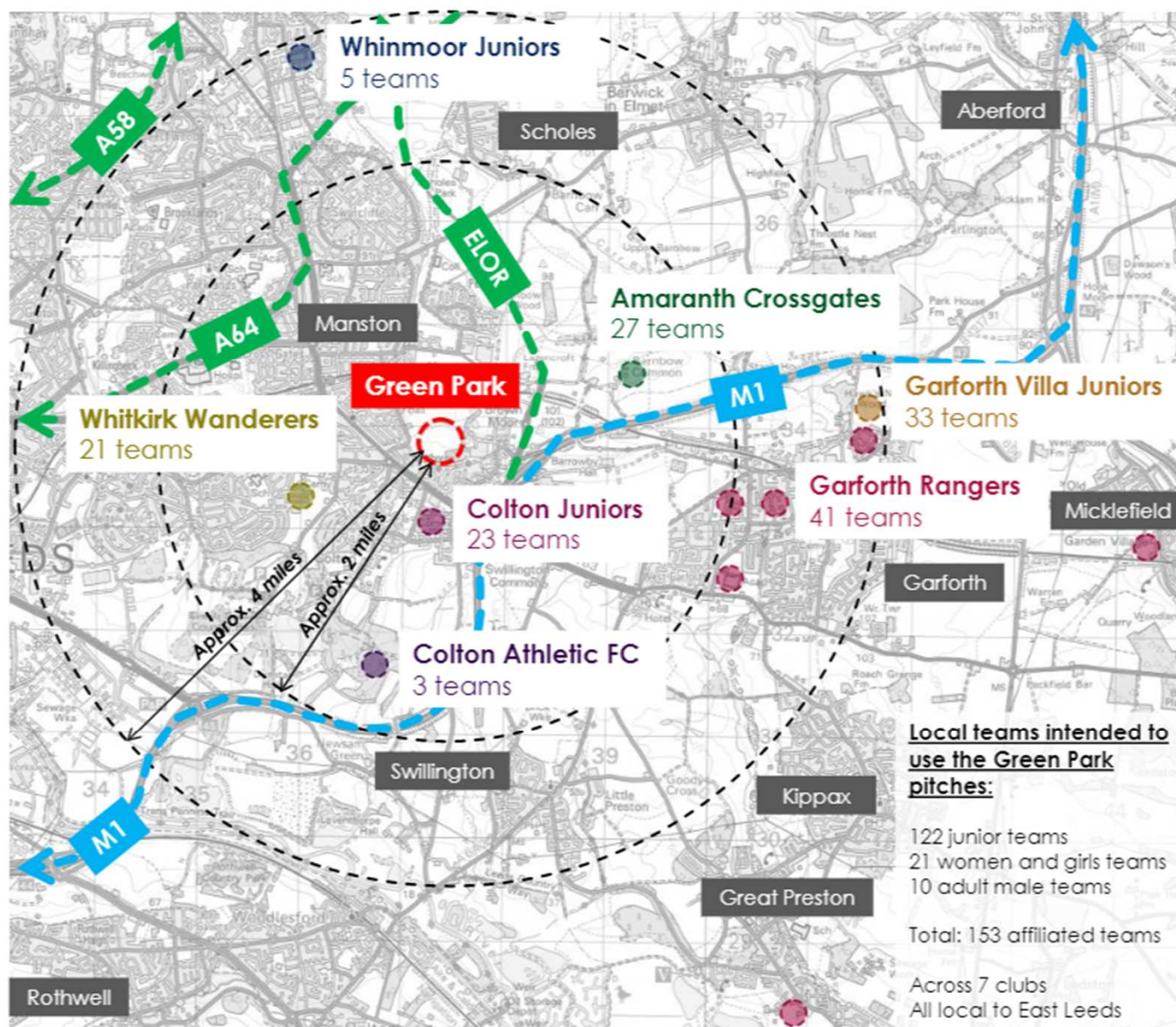

Existing map showing the local clubs intended to use the facility at Green Park

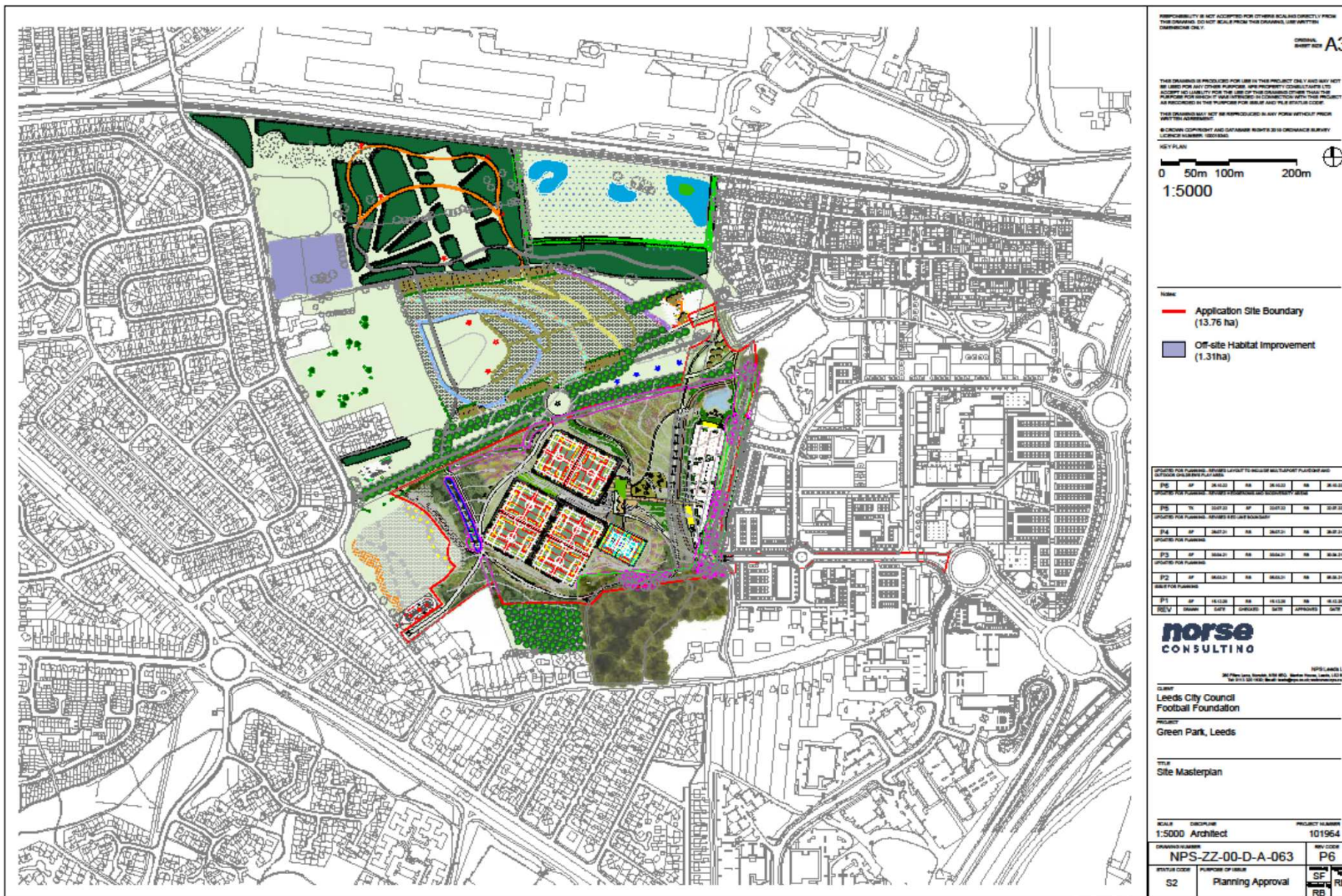



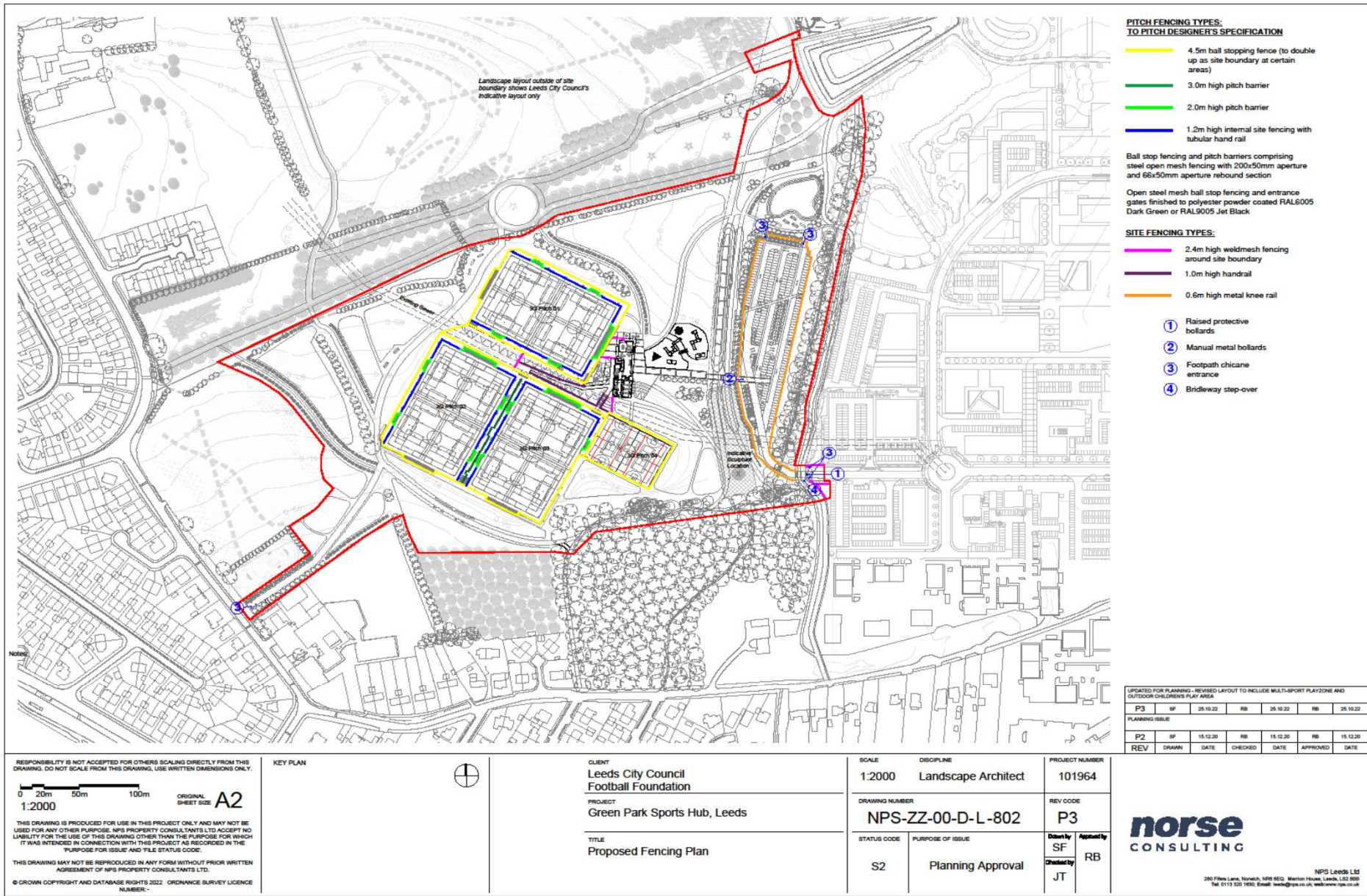

PITCH FENCING TYPES: TO PITCH DESIGNER'S SPECIFICATION

- 4.5m ball stopping fence (to double up as site boundary at certain areas)
- 3.0m high pitch barrier
- 2.0m high pitch barrier
- 1.2m high internal site fencing with tubular hand rail

Ball stop fencing and pitch barriers comprising steel open mesh fencing with 200x50mm aperture and 66x50mm aperture rebound section

Open steel mesh ball stop fencing and entrance gates finished to polyester powder coated RAL6005 Dark Green or RAL9005 Jet Black

SITE FENCING TYPES:

- 2.4m high weldmesh fencing around site boundary
- 1.0m high handrail
- 0.6m high metal knee rail

- ① Raised protective bollards
- ② Manual metal bollards
- ③ Footpath chicane entrance
- ④ Bridleway step-over

UPDATED FOR PLANNING - REVISED LAYOUT TO INCLUDE MULTI-SPORT PLAYZONE AND OUTDOOR CHILDREN'S PLAY AREA						
P3	SF	25.10.22	RB	25.10.22	RB	25.10.22
PLANNING ISSUE						
P2	SF	15.12.20	RB	15.12.20	RB	15.12.20
REV	DRAWN	DATE	CHECKED	DATE	APPROVED	DATE

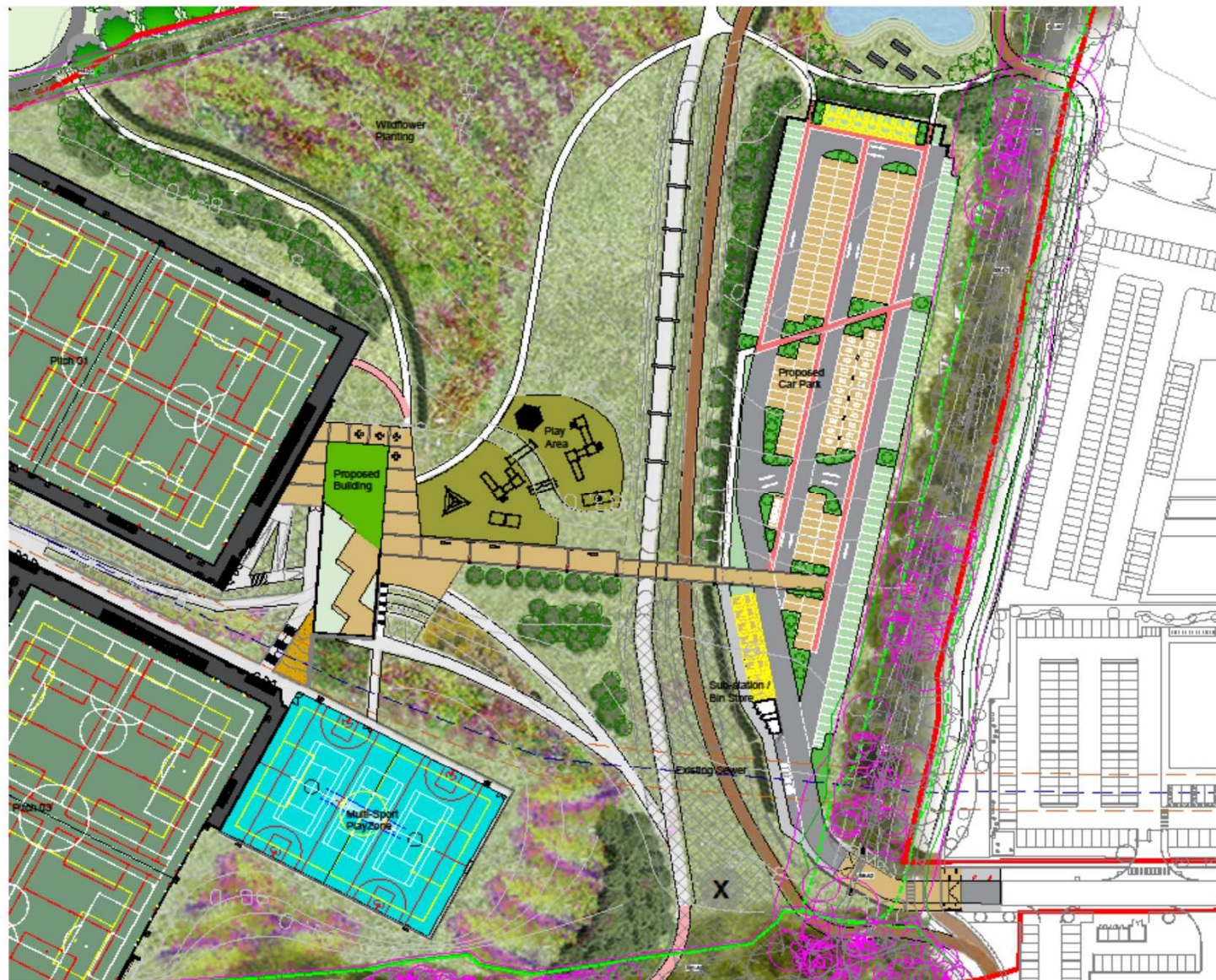

RESPONSIBILITY IS NOT ACCEPTED FOR OTHERS READING DIRECTLY FROM THIS DRAWING. DO NOT SCALE FROM THIS DRAWING. USE METRIC DIMENSIONS ONLY.

ORIGINAL
SHEET NO. A3

THIS DRAWING IS PROVIDED FOR USE IN THIS PROJECT ONLY AND MAY NOT BE USED FOR ANY OTHER PURPOSE. THE PROPERTY CONSULTANTS LTD ACCEPTS NO LIABILITY FOR THE USE OF THIS DRAWING OTHER THAN THE PURPOSE FOR WHICH IT WAS PREPARED. IN CONNECTION WITH THIS PROJECT, AS REQUIRED BY THE PURCHASER FOR SALE AND THE RESULTS CLOSE.

THIS DRAWING MAY NOT BE REPRODUCED IN ANY FORM WITHOUT PRIOR WRITTEN AGREEMENT.

© CROWN COPYRIGHT AND DATABASE RIGHTS 2010 ORDNANCE SURVEY
LICENCE NUMBER 10003340



Scale
0 10m 25m 50m
1:1000

Application Site Boundary

Proposed Vehicle Parking

Type	Total Proposed
Standard space	195
Accessible spaces	13
Motorcycles	16
Cycle spaces	14
EV charging bays	23
EV (accessible)	2
Coach drop-off	2

QUOTES FOR FURNISHING, MOBILE LAYOUT TO INCLUDE ALL NECESSARY PLANTING AND SOFTSCAPE ON THE SITE

Q/P	Q/P	Q/P	Q/P	Q/P	Q/P
Q/P1	Q/P2	Q/P3	Q/P4	Q/P5	Q/P6
Q/P1	Q/P2	Q/P3	Q/P4	Q/P5	Q/P6

QUOTES FOR FURNISHING

Q/P	Q/P	Q/P	Q/P	Q/P	Q/P
Q/P1	Q/P2	Q/P3	Q/P4	Q/P5	Q/P6
Q/P1	Q/P2	Q/P3	Q/P4	Q/P5	Q/P6

norse
CONSULTING

NPS/14001.1.01
300 Park Lane, Leeds, LS10 1JL
Tel: 0113 251 1111 Email: sales@norse-consulting.co.uk

CLIENT
Leeds City Council
Football Foundation

PROJECT
Green Park, Leeds

TITLE
Proposed Car Park

SCALE
1:1000 Architect

PROJECT NUMBER
101954

DRAWING NUMBER
NPS-ZZ-00-D-A-064

STATUS CODE
S2

PURPOSE OF DRAWING
Planning Approval

DATE
SF
RB

File Path: G:\Green Park\Leeds Sports Pavilion & Pitches\101954\Design\101954-A03-Drawing\Shed\Planning\Set\101954-NPS-CRA-00-002 - Proposed Site Planning, Saved: 26 October 2022 11:53:21, By: Planning, Serial

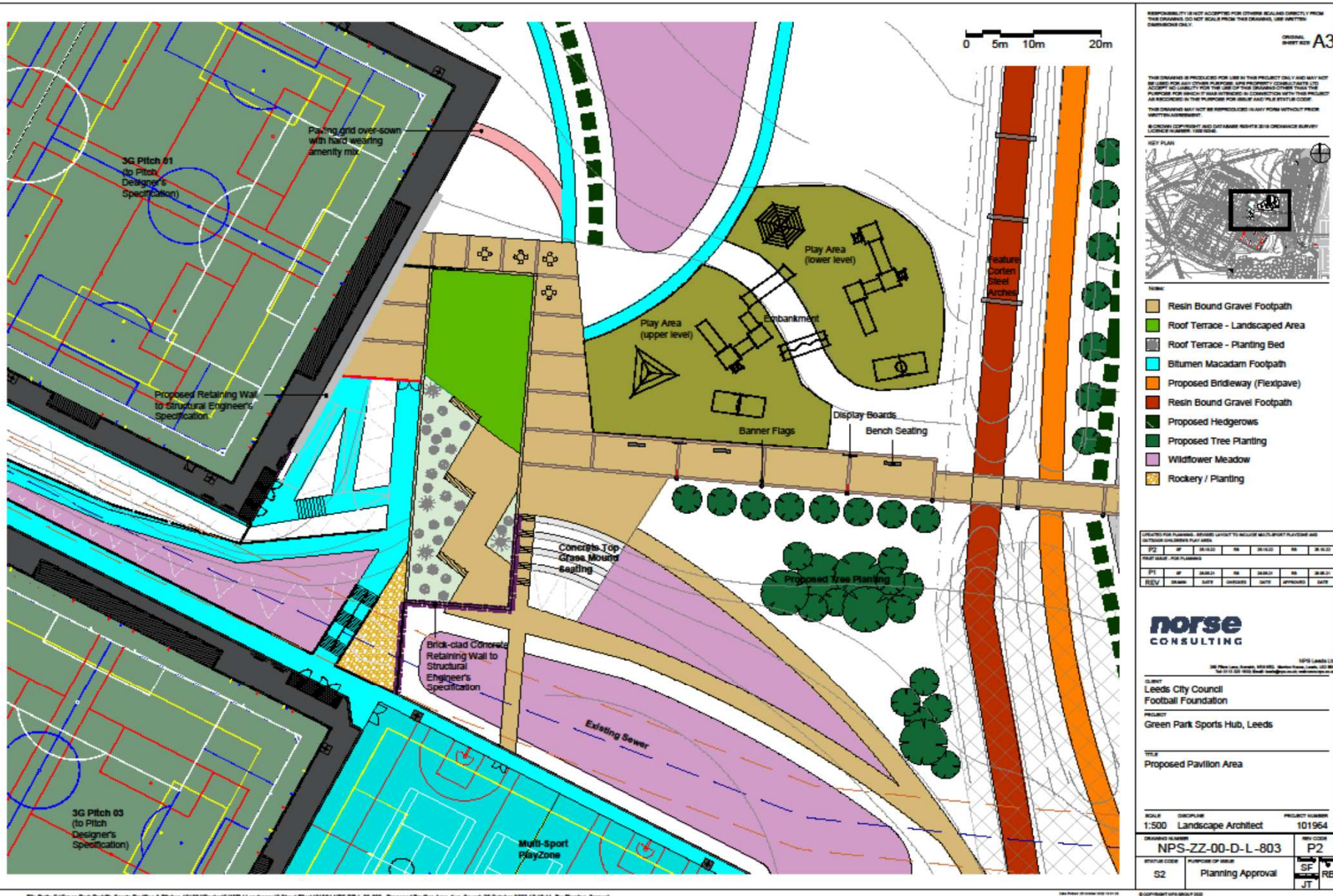

File Path: G:\Green Park Sports Hub & Pitches\101954\Design\2 NPS\4 Landscape\3 Sheet\101954-NPS-D-L-803 - Proposed Pavilion Area.dwg, Saved: 26 October 2022 13:10:11, By: Planning, Serial



PLANS PANEL

THURSDAY

END OF PRESENTATION



Doing our best – to be the Best Council in the Best City

33